

LEGION (TBD) 1907 St. Patrick St. Historic Rehab

Belle City Square sits on the grounds of the historic Horlick Factory, uniting the history of Racine with a modern reimagined vision. Through both historic redevelopment and new construction, the project brings hundreds of elevated apartment units and a mix of office and retail commercial space to the area. Ideal for a restaurant, taproom, beer garden, event space, small-format urban market, and/or health & wellness facility.

LEGION



17,592 SF (+ BASEMENT,
LL & MEZZANINE)
OF COMMERCIAL SPACE

- Restaurant Space
- Taproom
- Beer Garden
- Event Space
- Small-Format Urban Market
- Health/Wellness Facility

1st Floor: 11,067 SF
1st Floor Mezzanine: 612 SF
2nd Floor: 5,813
3rd Floor: 712 SF
Lower Level: 8,885 SF
Basement: 12,950 SF

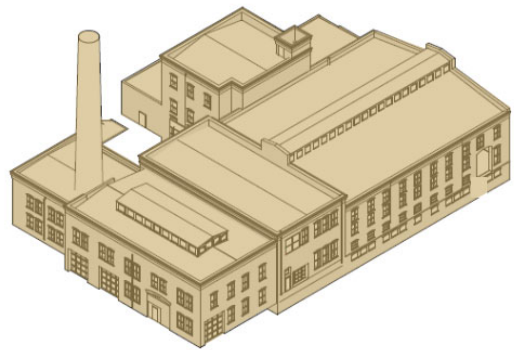

Legion 17,592 sf (+ basement, LL & mezzanine) of commercial space.

- 1st Floor – 11,067 SF
- 2nd Floor Mezzanine - 612 SF
- 2nd Floor – 5,813 SF
- 3rd Floor – 712 SF
- Lower Level – 8,885 SF
- Basement – 12,950 SF