

Building Department

Richard L. Heller
Chief Building Inspector



Room 307 – City Hall
730 Washington Avenue
Racine, Wisconsin 53403
262-636-9464
262-636-9329 Fax

M E M O

TO: Providers of Roll-Off Containers Placed in the Public Right-of-Way

FROM: Richard L. Heller
Chief Building Inspector

DATE: March 1, 2001

Recently the Racine Common Council passed an amendment to Ordinance 4-01 governing the placement of any type of container within a public street. These changes affect both the provider of the container and the party contracting for container services.

Requirements for the Provider of the Container

1. Insurance

No permit shall be issued under this section unless the applicant has provided proof of insurance as prescribed herein that is satisfactory to the City Attorney. The required insurance coverage shall specify applicability to the project for which a permit is being requested and shall name the city, its departments, officers, agents and employees as additional insureds for purposes of the project. Such insurance shall not be cancelable or limited in scope or coverage without 30 days prior written notice to the City Clerk, City of Racine, 730 Washington Avenue, Racine, WI 53403.

The following minimum coverage shall be provided:

- a. Comprehensive general liability insurance in an amount not less than \$250,000 property damage and \$500,000 bodily injury combined single limit written on an occurrence form.
- b. Comprehensive automobile liability coverage including owned, non-owned, and hired motor vehicles, as applicable, in an amount not less than \$500,000 per occurrence combined single limit written on an occurrence form.

2. Requirement for Reflective Tape

Red and white pattern reflective tape, minimum two (2) inches in width, shall be installed across the entire width of any side of the container that faces the direction of traffic. Such reflective tape shall be placed above the midpoint of the container as specified in Federal Motor Vehicle Safety Standard 108 (49 CFR 571.108), 55.7 Conspicuity System.

Requirements for the Party Contracting for Container Services (Permittee)

1. Permittee shall provide traffic control devices in accordance with the Manual on Uniform Traffic Control Devices and as shown on the attached drawings.
2. The maximum amount of time that a container can be placed on the street is four (4) months.

The requirements for traffic control devices and insurance are effective immediately. The requirement to install reflective tape shall go into effect beginning May 1, 2001.

Failure to provide reflective tape, or proper traffic control devices may result in a citation and the Department of Public Works rectifying the unsafe condition and invoicing the appropriate party for the work performed.

Failure to secure a permit prior to placement of a container within a street will result in higher fees and/or a citation.



If you have any questions, please don't hesitate to contact the Building Department at **636-9464**.

Roll off Container in Traffic Lane

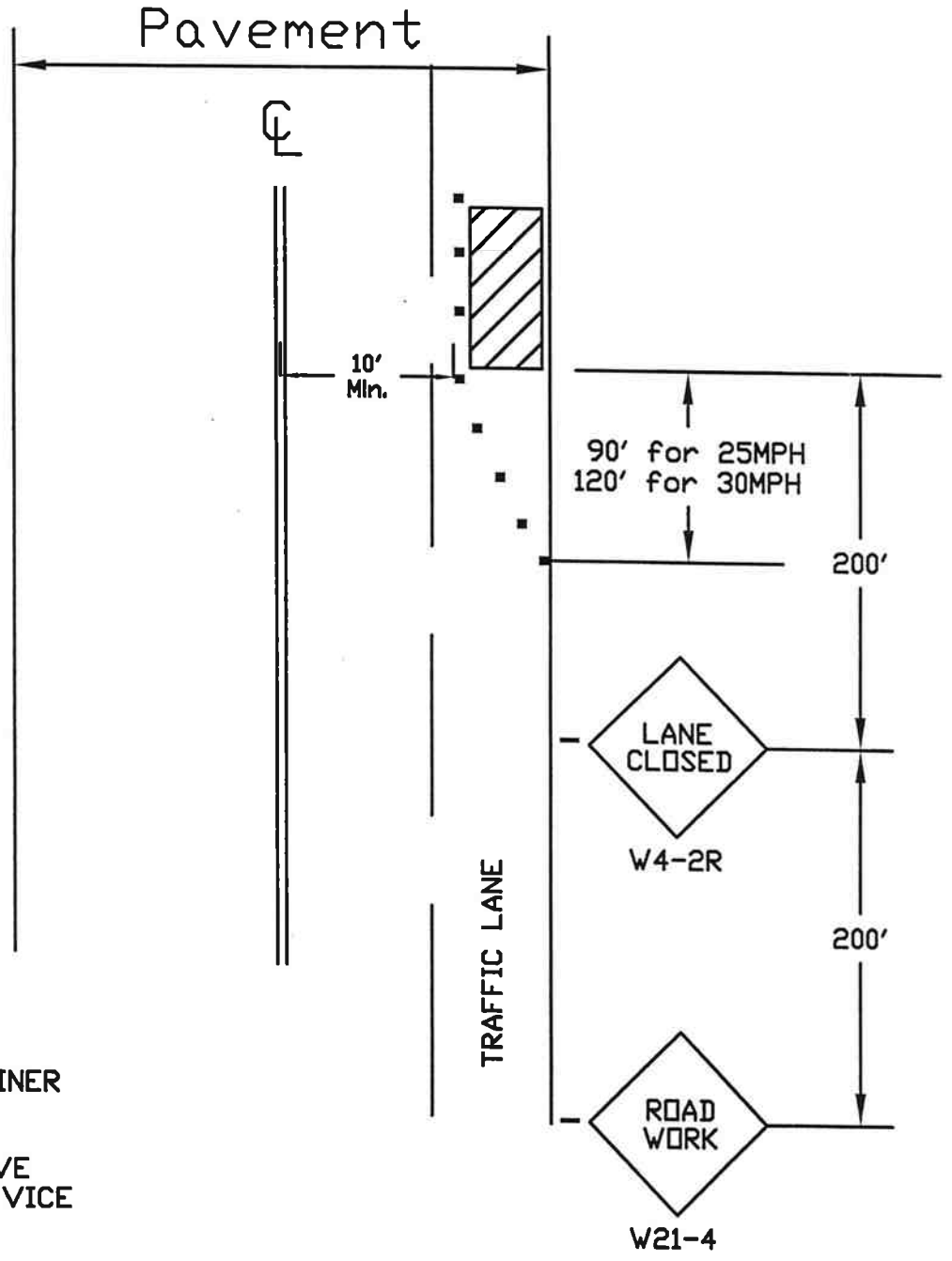
Typical Traffic Controls for Closure of Traffic Lane



LEGEND

-  ROLL OFF CONTAINER
-  RETRO-REFLECTIVE CHANNELIZING DEVICE

Note: When Roll Off Containers are placed in a traffic lane, use guidelines described in Part VI of the MUTCD

Standards and Guides for Traffic Controls for Street and Highway Construction, Maintenance, Utility, and Incident Management Operations.

CITY ENGINEER'S OFFICE RACINE, WISCONSIN

APPROVED :

DATE :

DRAWN : SRH

DATE : 3-16-01

CODE :

Revisions :

Scale : NOT TO SCALE



FILE NUMBER :

Roll off Container in Parking Lane

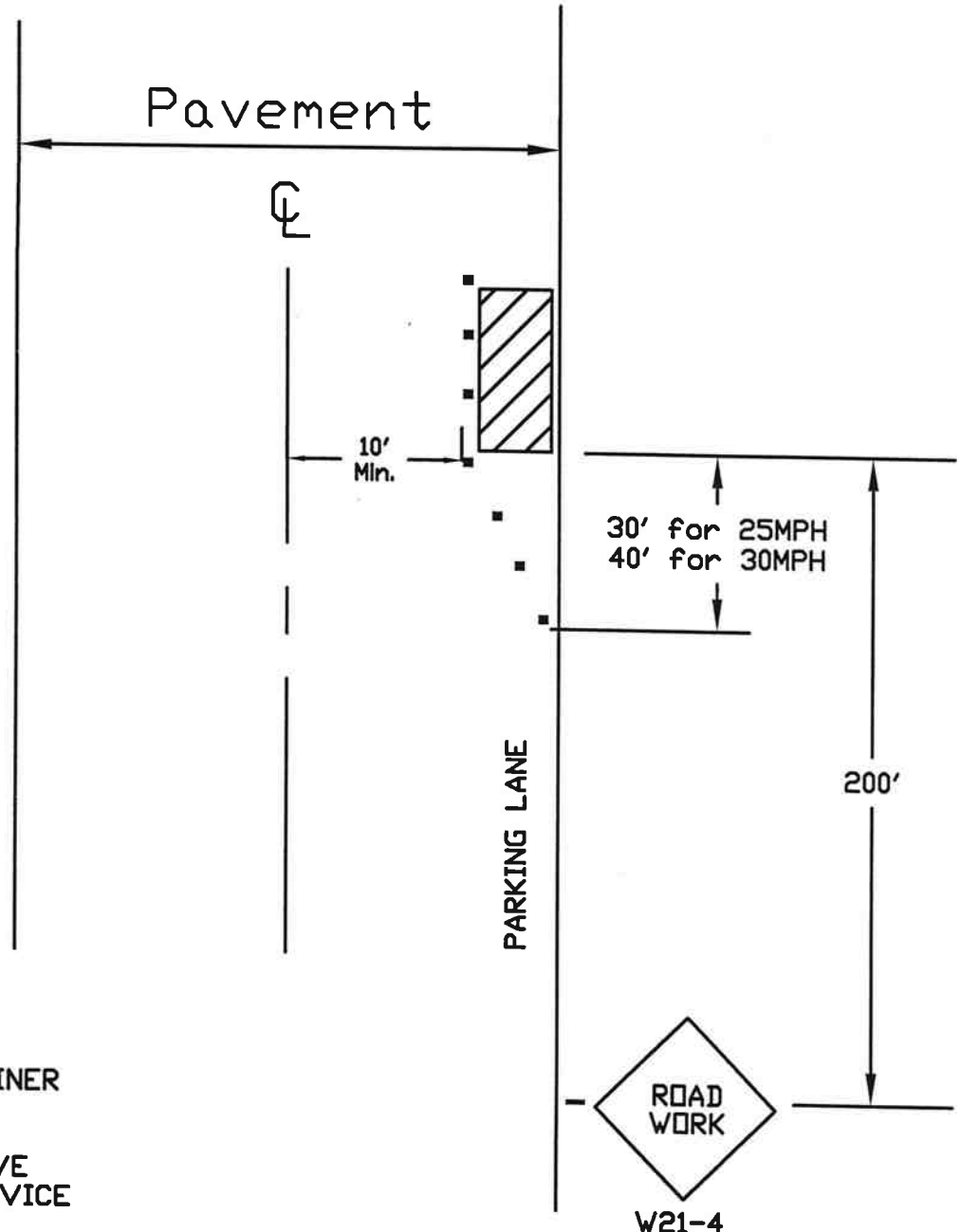
Typical Traffic Controls for Closure of Parking Lane



LEGEND

-  ROLL OFF CONTAINER
-  RETRO-REFLECTIVE CHANNELIZING DEVICE

Note: When Roll Off Containers are placed in traffic lanes, use guidelines described in Part VI of the MUTCD Standards and Guides for Traffic Controls for Street and Highway Construction, Maintenance, Utility, and Incident Management Operations.

CITY ENGINEER'S OFFICE RACINE, WISCONSIN

APPROVED :

DATE :

DRAWN : SRH

DATE : 3-16-01

CODE :

Revisions :

Scale : NOT TO SCALE



FILE NUMBER :

Roll off Container in Parking Metered Space

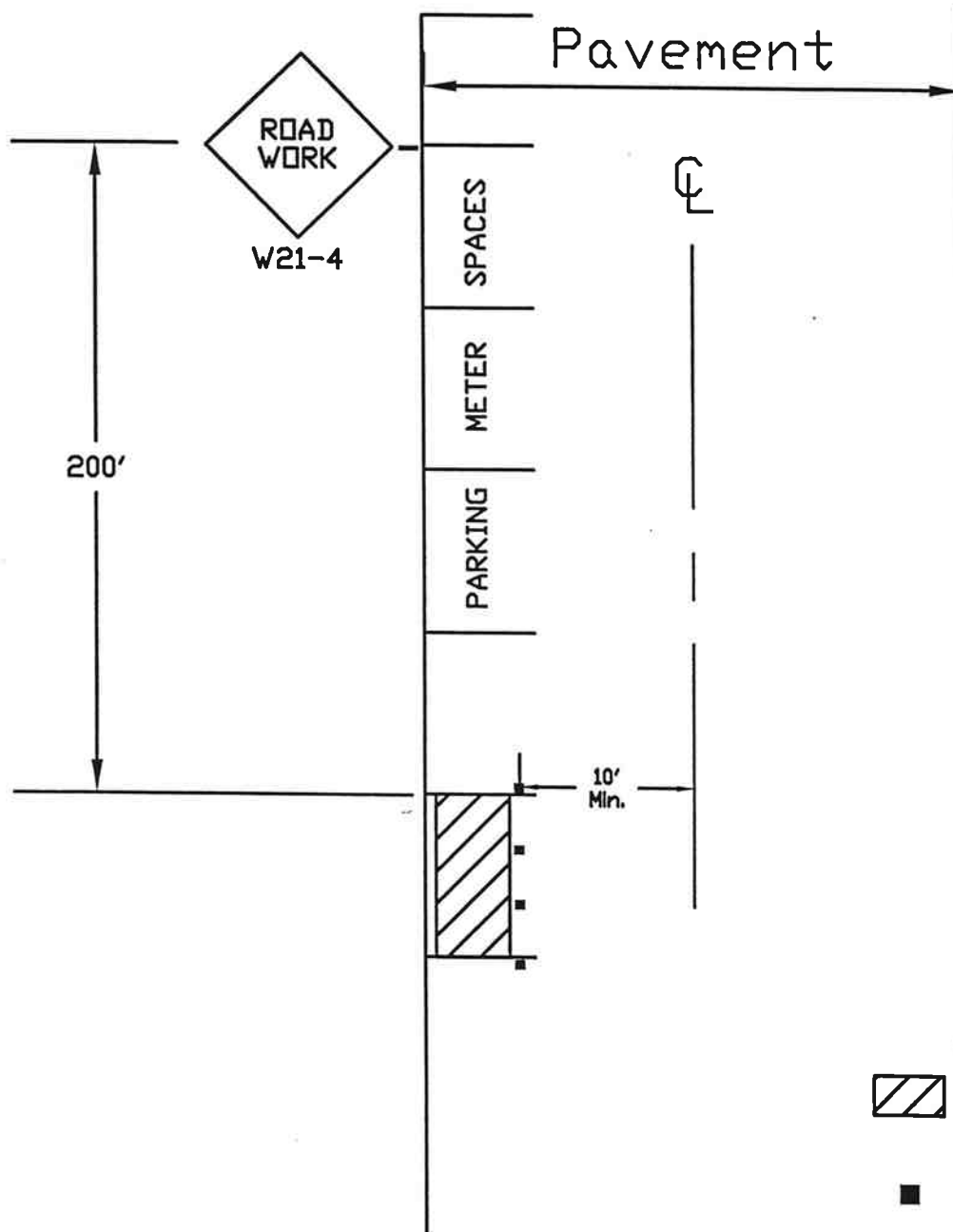
Typical Traffic Controls for Closure of Parking Meter Space



LEGEND

-  ROLL OFF CONTAINER
-  RETRO-REFLECTIVE CHANNELIZING DEVICE

Note: When Roll Off Containers are placed in traffic lanes, use guidelines described in Part VI of the MUTCD Standards and Guides for Traffic Controls for Street and Highway Construction, Maintenance, Utility, and Incident Management Operations.

CITY ENGINEER'S OFFICE RACINE, WISCONSIN

APPROVED :

DATE :

DRAWN : SRH

DATE : 3-16-01

Revisions :

Scale : NOT TO SCALE

CODE :

FILE NUMBER :